

T.I.S.

PN 10 - Art. C070 TIS

PN 16 - Art. C071 TIS

VALVOLA DI RITEGNO A CLAPET PN10/16

SWING CHECK VALVE PN10/16

APPLICAZIONE:

Installazione per acqua fredda, e fluidi non aggressivi.

APPLICATION:

Suitable for cold water and not acidic fluid water installation.

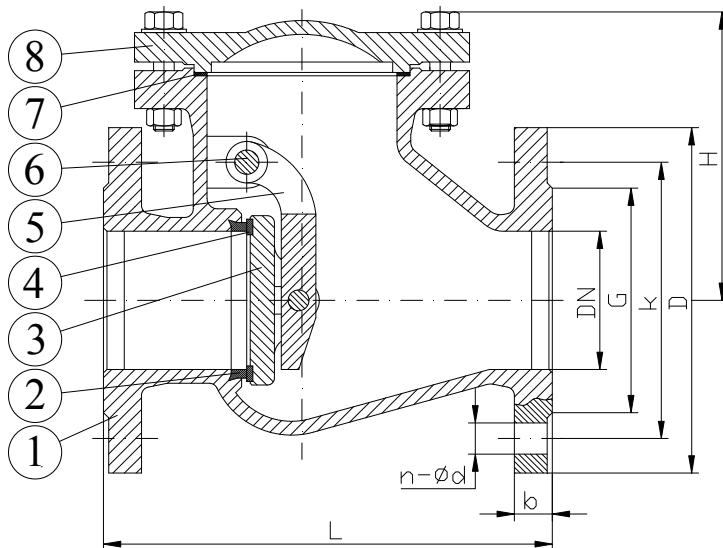
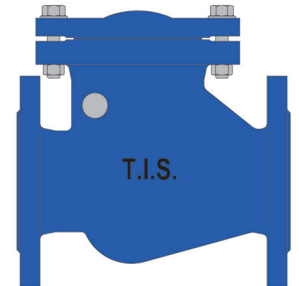

NORMA PROGETTO:	EN 1074-3
SCARTAMENTO:	EN 558 Serie48
FLANGE:	EN 1092-2
COLLAUDI:	EN 12266-1
TEMP. ESERCIZIO:	Max. +80°C
CONTROPRESSIONE:	Min. 0,3/0,5 bar
DESIGN STANDARD:	EN 1074-3
FACE TO FACE:	EN 558 Series48
FLANGES:	EN 1092-2
TESTS:	EN 12266-1
WORKING TEMP.:	Max. +80°C
BACKPRESSURE:	Min. 0,3/0,5 bar

COLORE: Blu RAL 5017.

COLOUR: Blue RAL 5017.

DENOMINAZIONE PART	MATERIALI MATERIALS
1 CORPO <i>BODY</i>	EN-GJL 250 <i>EN-GJL 250</i>
2 TENUTA CORPO <i>BODY SEAL RING</i>	OTTONE <i>BRASS</i>
3 DISCO <i>DISC</i>	EN-GJL 250 <i>EN-GJL 250</i>
4 TENUTA DISCO <i>DISC SEAL RING</i>	EPDM <i>EPDM</i>
5 LEVA <i>LEVER</i>	EN-GJS 400-15 <i>EN-GJS 400-15</i>
6 PERNO <i>LEVER PIN</i>	ACC.INOX AISI420 (EN 1.4021) <i>SS AISI420 (EN 1.4021)</i>
7 GUARNIZIONE <i>GASKET</i>	GRAFITE <i>GRAPHITE</i>
8 CAPPELLO <i>BONNET</i>	EN-GJL 250 <i>EN-GJL 250</i>

DN	G		K		D		L	H	b		n-ød		W (kg)
	PN10	PN16	PN10	PN16	PN10	PN16			PN10	PN16	PN10	PN16	
40	84	84	110	110	150	150	180	120	18	18	4-19	4-19	11.5
50	99	99	125	125	165	165	200	140	20	20	4-19	4-19	13.6
65	118	118	145	145	185	185	240	150	20	20	4-19	4-19	21
80	132	132	160	160	200	200	260	165	22	22	8*-19	8-19	26.5
100	156	156	180	180	220	220	300	175	24	24	8-19	8-19	32
125	184	184	210	210	250	250	350	198	26	26	8-19	8-19	45
150	211	211	240	240	285	285	400	229	26	26	8-23	8-23	71.5
200	266	266	295	295	340	340	500	249	26	30	8-23	12-23	95
250	319	319	350	355	395	405	600	310	28	32	12-23	12-28	139
300	370	370	400	410	445	460	700	322	28	32	12-23	12-28	188
350	429	429	460	470	505	520	800	390	30	36	16-23	16-28	275
400	480	480	515	525	565	580	900	445	32	38	16-28	16-31	340

*Disponibile anche con 4 fori / *Available also with 4 holes